

### YF-338 COOL ROOM HANDLE

Material : High pressure die-cast zinc.  
Finish : Highly polished chrome plated.

Packing : 1 body and strike per box, then 4 boxes per carton.  
Offset : Adjustable height from 40.0mm to 58.0mm.  
Action : Door of big or medium refrigerator.

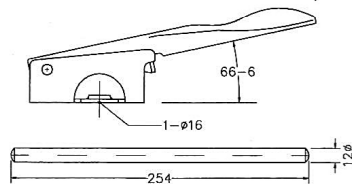

### YF-601 COOL ROOM HANDLE

1. Material : High pressure die-cast zinc.  
2. Finish : Highly polished chrome plated.  
3. Packing : 1 body and strike per box, then 10 boxes per carton.  
Offset : Adjustable height from 45.0mm to 70.0mm.  
Action : Door of big or medium refrigerator.

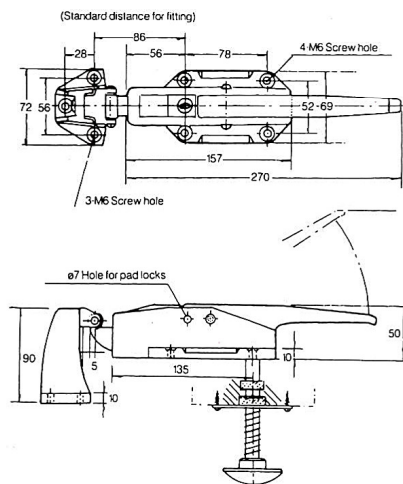

### YF-311 HANDLE

Material : High pressure die-cast zinc.  
Finish : Highly polished chrome plated.  
Packing : 1 body and strike per box, then 50 boxes per carton.  
Offset : Standard strike adjustable from 18.0mm to 22.0mm.  
Action : Door of big or medium refrigerator.

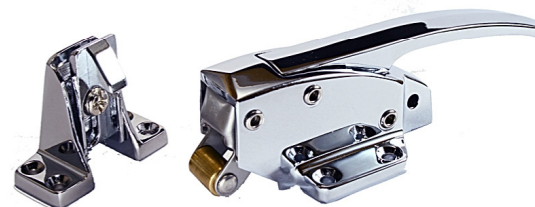
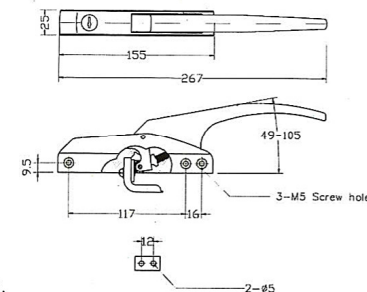

### YF-101 HANDLE

Material : High pressure die-cast zinc.  
Finish : Highly polished chrome plated.  
Packing : 50 pcs per carton.  
Offset : Adjustable height from 18.0mm to 32.0mm.  
Action : Door of small or medium refrigerator.

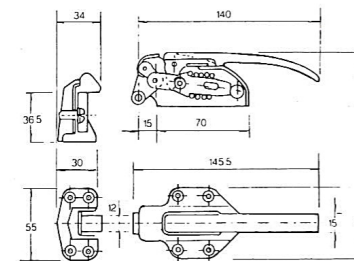

### YF-1300 HANDLE

Material : High pressure die-cast zinc.  
Finish : Highly polished chrome plated.  
Packing : 50 pcs per carton.  
Offset : Adjustable height from 18.0mm to 32.0mm.  
Action : Door of small or medium refrigerator.

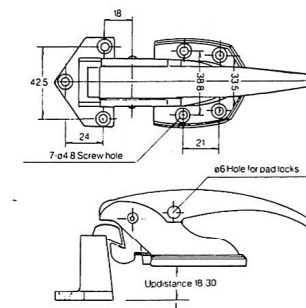



**YF-612**  
**HINGES**

Material : High pressure die-cast zinc.  
Finish : Highly polished chrome plated.  
Packing : 5 pairs per carton.  
Action : Door of medium refrigerator.  
Offset : Adjustable height.  
form 50 mm to 70 mm  
Speciality : Can be used for left or right door.

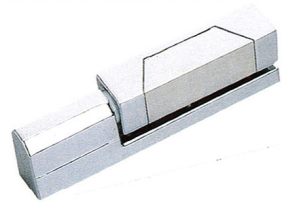
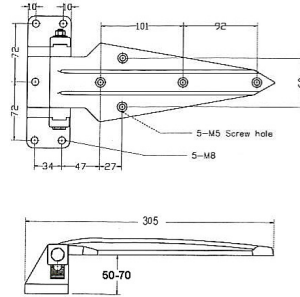

**YF-1132**  
**HINGES**

Material : High pressure die-cast zinc.  
Finish : Highly polished chrome plated.  
Packing : 50 pcs (25 pairs) per carton.  
Speciality : Self-closing, cam-lift hing of left or right doors, automatic close within 95° angle or stay open beyond 120° angle.  
Action : Light dor of big or medium refrigerator.

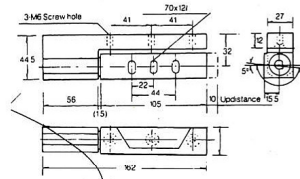

**YF-302**  
**HINGES**

Material : High pressure die-cast zinc.  
Finish : Highly polished chrome plated.  
Packing : 100 pcs per carton.  
Speciality : install for left or right door.  
Action : Various doors.

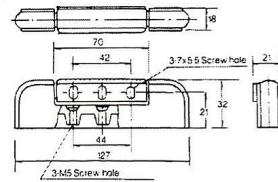

**YF-102**  
**HINGES**

Material : High pressure die-cast zinc.  
Finish : Highly polished chrome plated.  
Packing : 100 pcs (50 pairs) per carton.  
Speciality : Install for left or right door.  
Action : Various doors.

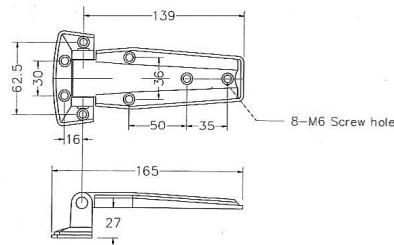

**HAND VALVE FLARE**

SVD-04-1/4"  
SVD-06-3/8"  
SVD-08-1/2"  
SVD-10-5/8"  
SVD-12-3/4"

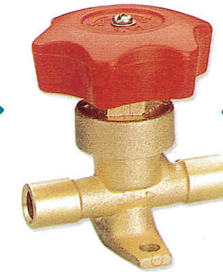

**HAND VALVE SOLDER**

ODS-04-1/4"  
ODS-06-3/8"  
ODS-08-1/2"  
ODS-10-5/8"  
ODS-12-3/4"  
ODS-14-7/8"

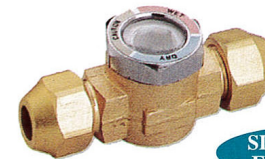

**SIGHT GLASS FLARE TYPE**

SG-04-1/4"  
SG-06-3/8"  
SG-08-1/2"  
SG-10-5/8"  
SG-12-3/4"

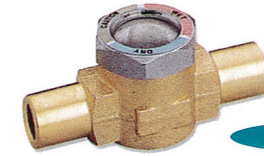

**SOLDER TYPE**

SG-04S-1/4"  
SG-06S-3/8"  
SG-08S-1/2"  
SG-10S-5/8"  
SG-12S-3/4"  
SG-14S-7/8"

**SOLDER UNION**

With 6cm or 10cm Extension cooper tube.  
SU-02 1/8"O.D.  
SU-03 3/16"O.D.  
SU-04 1/4"O.D.  
SU-05 5/16"O.D.  
SU-06 3/8"O.D.

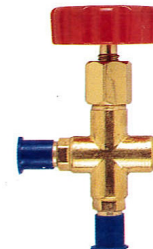

**SINGLE VALVE**

466-G  
1/4" SAE x 1/4" SAE x 1/4 NPT

**RECEIVER VALVE**

RV-04 x 04  
1/4 SAE x 1/4 NPT  
RV-04 x 06  
1/4 SAE x 3/8 NPT  
RV-06 x 06  
3/8 SAE x 3/8 NPT

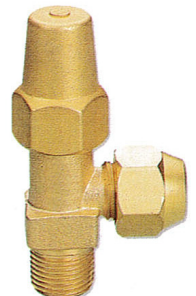



**COMPRESSOR VALVE**

**CV-307**

Solder-type-forged brass body, the maximum working pressure is 500PSI, Tube Size : 3/4", 7/8", 1-1/8", the parts include one asbestos pad, two bolts.

**SPLIT AIR-CONDITIONER VALVE**



**SA-04 1/4"**  
2 way valve  
1/4" inlet  
1/4" flare outlet



**SA-06 3/8"**  
**SA-08 1/2"**  
**SA-10 5/8"**  
3 way valve  
3/8" or 1/2" or 5/8" inlet  
3/8" or 1/2" or 5/8" flare outlet  
1/4" charging inlet with valve core

**SPLIT AIR-CONDITIONER VALVE**



Special air conditioner valves are available from 1/4" to 5/8".  
Welcome any air conditioner manufacturers to cooperate.

**ADJUSTABLE QUICK COUPLER**



**QC-23H**

High pressure quick couplers fitted with 14mm female thread.

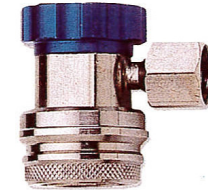

**QC-23L**

Low pressure quick couplers fitted with 14mm female thread.

**QUICK COUPLER**

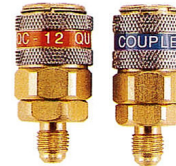

**QC-12**

High pressure & low pressure quick couplers fitted with 1/4" SAE.



**QC-13**

High pressure & low pressure quick couplers fitted with M12 x 1.75, M10 x 1.5

**CHARGING HOSE FOR R12**

1/4" SAE connection. 3000 PSI burst 600 PSI max W.P.

- YF-336RYB** 3pcs 36" hose set.
- YF-360RYB** 3pcs 60" hose set.
- YF-372RYB** 3pcs 72" hose set.
- YF-396RYB** 3pcs 96" hose set.

\*\*\*Special length or individual Charging hose are also available.\*\*\*



**CHARGING HOSE FOR R410a**

1/4" & 5/16 SAE connection.  
4000 PSI burst 870 PSI max W.P.

- YF-336RYB-410** 3pcs 36" hose set.
- YF-360RYB-410** 3pcs 60" hose set.
- YF-372RYB-410** 3pcs 72" hose set.



**CHARGING HOSE FOR R134a**

1/2" ACME connection

- YF-336RYG-S** 3pcs 36" hose set.
- YF-360RYG-S** 3pcs 60" hose set.
- YF-372RYG-S** 3pcs 72" hose set.

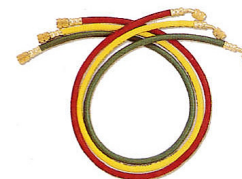

### MANIFOLD SET

#### YF-600

Without sight glass brass testing manifold body with hook, hose holder and two handwheels.

#### YF-636

Manifold for R12  
Testing manifold set, YF-600 assembled with one compound / pressure gauge and 3 pcs 36" charging hoses.  
Packed in a carton box per set.

#### YF-660

With 3pcs 60" charging hoses.

#### YF-672

With 3pcs 72" charging hoses.

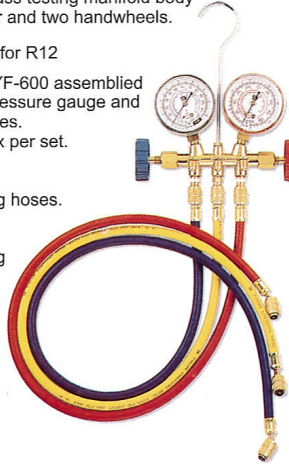

#### YF-500

With sight glass brass testing manifold body with hook, hose holder and two handwheels.

#### YF-536

Testing sight glass brass testing manifold with one compound / pressure gauge and 3 pcs 36" charging hoses for R12.  
Packed in a carton box per set.

#### YF-560

With 3pcs 60" charging hoses.

#### YF-572

With 3pcs 72" charging hoses.



### MANIFOLD SET

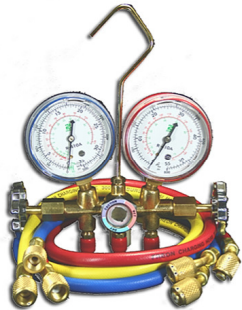

Testing sight glass brass testing manifold with hook, hose holder, 3pcs charging hoses 2 compound / pressure gauge for R410a & R32 and 2 alloy handwheels.

Packed in a carton box per set

#### YF-436

With 3pcs 36" charging hoses for R410a

#### YF-436

With 3pcs 60" charging hoses for R410a

#### YF-436

With 3pcs 72" charging hoses for R410a

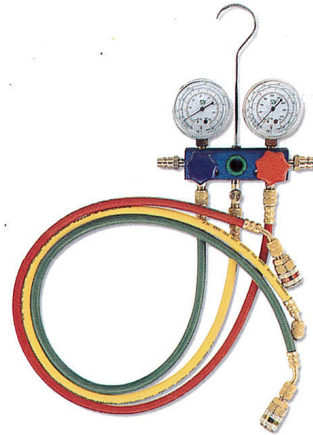

Manifold with 3 pcs hoses, 2pcs quick couplers. 1/4" SAE connection for R134a.

#### YF-236

With 3pcs 36" hoses.

#### YF-260

With 3pcs 60" hoses.

#### YF-272

With 3pcs 72" hoses.

**MULTI SIZE SOLDER UNION**  
MSU-7000  
for 1/8", 3/16", 1/4", 5/16", 3/8", 1/2" O.D. tubing with valve core.

**CHARGING FITTING**  
SF-628-04  
1/4" x 1/4" flare with valve core

NF-627-04x02  
1/4" x 1/8" NPT

NF-627-04x04  
1/4" x 1/4" NPT with valve core.

**CYLINDER ADAPTER**

CA-05x12  
1/2" ACME x 3/4" PS. thread R134a use.

**COPPER SEAL CAP**

CS-12 -3/4"  
CS-10 -5/8"  
CS-08 -1/2"  
CS-06 -3/8"  
CS-04 -1/4"

**CYLINDER ADAPTER**

CA-04x12  
1/4" flare x 3/4" PS. thread R12 use.

**CYLINDER ADAPTER**

CA-04x08  
1/2" Male ACME with o-ring x 1/4" M.F.

CA-04x05  
1/4" flare male x 1/2" ACME female

CA-05x04  
1/2" ACME male x 1/4" flare female

CA-06x08  
1/2" Male ACME with o-ring x 1/4" M.F.

**CYLINDER ADAPTER**

CA-03x12  
10mm x 3/4" PS. thread R134a use.

**UNION TEE**

UT-04 -1/4"  
UT-06 -3/8"  
UT-08 -1/2"  
UT-10 -5/8"  
UT-12 -3/4"

UF-682-04x04  
1/4" x 1/4" x 1/4"

UF-682-04x02  
1/4" x 1/4" x 1/8" NPS

UF-672-04x02  
1/4" x 1/4" x 1/4" NPT

**90° ELBOW**

ME-04x02  
1/4" flare x 1/8" NPT

ME-04x04  
1/4" flare x 1/4" NPT

**CAPILLARY TUBE WITH NUT**













YF-900-M  
The product is designed specially pressure indicating instruments for refrigeration industry. This capillary tube is 1/8" and two flared tube are 1/4" with low 1/4" copper nuts length is 90cm total.

**TWIN NUT**

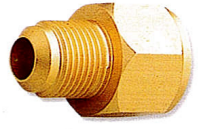
Item No.	Tube O.D. IN
TW-04	1/4
TW-05	5/16
TW-06	3/8
TW-08	1/2
TW-10	5/8
TW-12	3/4

**UNION ELBOW**

Item No.	Tube O.D. IN
UE-04	1/4 x 1/4
UE-06	3/8 x 3/8
UE-08	1/2 x 1/2
UE-10	5/8 x 5/8
UE-12	3/4 x 3/4

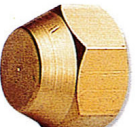
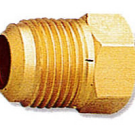
<p><b>LONG NUT</b></p>  <table border="1"> <thead> <tr> <th>Item No.</th> <th>Tube O.D.</th> <th>IN</th> </tr> </thead> <tbody> <tr><td>SN1-04</td><td>1/4</td><td></td></tr> <tr><td>SN1-05</td><td>5/16</td><td></td></tr> <tr><td>SN1-06</td><td>3/8</td><td></td></tr> <tr><td>SN1-08</td><td>1/2</td><td></td></tr> <tr><td>SN1-10</td><td>5/8</td><td></td></tr> <tr><td>SN1-12</td><td>3/4</td><td></td></tr> </tbody> </table>	Item No.	Tube O.D.	IN	SN1-04	1/4		SN1-05	5/16		SN1-06	3/8		SN1-08	1/2		SN1-10	5/8		SN1-12	3/4		<p><b>SWIVEL NUT</b></p>  <table border="1"> <thead> <tr> <th>Item No.</th> <th>Outlet O.D.</th> <th>Inlet O.D.</th> </tr> </thead> <tbody> <tr><td>RN-03 x 04</td><td>3/16</td><td>1/4</td></tr> <tr><td>RN-04 x 06</td><td>1/4</td><td>3/8</td></tr> <tr><td>RN-06 x 08</td><td>3/8</td><td>1/2</td></tr> <tr><td>RN-08 x 10</td><td>1/2</td><td>5/8</td></tr> <tr><td>RN-10 x 12</td><td>5/8</td><td>3/4</td></tr> </tbody> </table>	Item No.	Outlet O.D.	Inlet O.D.	RN-03 x 04	3/16	1/4	RN-04 x 06	1/4	3/8	RN-06 x 08	3/8	1/2	RN-08 x 10	1/2	5/8	RN-10 x 12	5/8	3/4	<p><b>FLARE TO SOLDER UNION</b></p>  <table border="1"> <thead> <tr> <th>Item No.</th> <th>Tube O.D.</th> <th>IN</th> </tr> </thead> <tbody> <tr><td>FSU-04 x 04</td><td>1/4</td><td>1/4</td></tr> <tr><td>FSU-04 x 06</td><td>1/4</td><td>3/8</td></tr> <tr><td>FSU-06 x 06</td><td>3/8</td><td>3/8</td></tr> <tr><td>FSU-06 x 04</td><td>3/8</td><td>1/4</td></tr> <tr><td>FSU-06 x 08</td><td>3/8</td><td>1/2</td></tr> <tr><td>FSU-08 x 06</td><td>1/2</td><td>3/8</td></tr> <tr><td>FSU-08 x 08</td><td>1/2</td><td>1/2</td></tr> <tr><td>FSU-08 x 10</td><td>1/2</td><td>5/8</td></tr> <tr><td>FSU-10 x 10</td><td>5/8</td><td>5/8</td></tr> <tr><td>FSU-10 x 08</td><td>5/8</td><td>1/2</td></tr> <tr><td>FSU-10 x 06</td><td>5/8</td><td>3/8</td></tr> <tr><td>FSU-12 x 12</td><td>3/4</td><td>3/4</td></tr> <tr><td>FSU-12 x 10</td><td>3/4</td><td>5/8</td></tr> <tr><td>FSU-12 x 08</td><td>3/4</td><td>1/2</td></tr> </tbody> </table>	Item No.	Tube O.D.	IN	FSU-04 x 04	1/4	1/4	FSU-04 x 06	1/4	3/8	FSU-06 x 06	3/8	3/8	FSU-06 x 04	3/8	1/4	FSU-06 x 08	3/8	1/2	FSU-08 x 06	1/2	3/8	FSU-08 x 08	1/2	1/2	FSU-08 x 10	1/2	5/8	FSU-10 x 10	5/8	5/8	FSU-10 x 08	5/8	1/2	FSU-10 x 06	5/8	3/8	FSU-12 x 12	3/4	3/4	FSU-12 x 10	3/4	5/8	FSU-12 x 08	3/4	1/2
Item No.	Tube O.D.	IN																																																																																				
SN1-04	1/4																																																																																					
SN1-05	5/16																																																																																					
SN1-06	3/8																																																																																					
SN1-08	1/2																																																																																					
SN1-10	5/8																																																																																					
SN1-12	3/4																																																																																					
Item No.	Outlet O.D.	Inlet O.D.																																																																																				
RN-03 x 04	3/16	1/4																																																																																				
RN-04 x 06	1/4	3/8																																																																																				
RN-06 x 08	3/8	1/2																																																																																				
RN-08 x 10	1/2	5/8																																																																																				
RN-10 x 12	5/8	3/4																																																																																				
Item No.	Tube O.D.	IN																																																																																				
FSU-04 x 04	1/4	1/4																																																																																				
FSU-04 x 06	1/4	3/8																																																																																				
FSU-06 x 06	3/8	3/8																																																																																				
FSU-06 x 04	3/8	1/4																																																																																				
FSU-06 x 08	3/8	1/2																																																																																				
FSU-08 x 06	1/2	3/8																																																																																				
FSU-08 x 08	1/2	1/2																																																																																				
FSU-08 x 10	1/2	5/8																																																																																				
FSU-10 x 10	5/8	5/8																																																																																				
FSU-10 x 08	5/8	1/2																																																																																				
FSU-10 x 06	5/8	3/8																																																																																				
FSU-12 x 12	3/4	3/4																																																																																				
FSU-12 x 10	3/4	5/8																																																																																				
FSU-12 x 08	3/4	1/2																																																																																				
<p><b>SHORT NUT</b></p>  <table border="1"> <thead> <tr> <th>Item No.</th> <th>Tube O.D.</th> <th>IN</th> </tr> </thead> <tbody> <tr><td>SN2-04</td><td>1/4</td><td></td></tr> <tr><td>SN2-05</td><td>5/16</td><td></td></tr> <tr><td>SN2-06</td><td>3/8</td><td></td></tr> <tr><td>SN2-08</td><td>1/2</td><td></td></tr> <tr><td>SN2-10</td><td>5/8</td><td></td></tr> </tbody> </table>	Item No.	Tube O.D.	IN	SN2-04	1/4		SN2-05	5/16		SN2-06	3/8		SN2-08	1/2		SN2-10	5/8		<p><b>UNION</b></p>  <table border="1"> <thead> <tr> <th>Item No.</th> <th>Tube O.D.</th> <th>IN</th> </tr> </thead> <tbody> <tr><td>U-04</td><td>1/4</td><td></td></tr> <tr><td>U-05</td><td>5/16</td><td></td></tr> <tr><td>U-06</td><td>3/8</td><td></td></tr> <tr><td>U-08</td><td>1/2</td><td></td></tr> <tr><td>U-10</td><td>5/8</td><td></td></tr> <tr><td>U-12</td><td>3/4</td><td></td></tr> </tbody> </table>	Item No.	Tube O.D.	IN	U-04	1/4		U-05	5/16		U-06	3/8		U-08	1/2		U-10	5/8		U-12	3/4		<p><b>MALE CONNECTOR</b></p>  <table border="1"> <thead> <tr> <th>Item No.</th> <th>Tube O.D.</th> <th>IN NPT</th> </tr> </thead> <tbody> <tr><td>MC-04 x 02</td><td>1/4</td><td>1/8</td></tr> <tr><td>MC-04 x 04</td><td>1/4</td><td>1/4</td></tr> <tr><td>MC-04 x 06</td><td>1/4</td><td>3/8</td></tr> <tr><td>MC-06 x 06</td><td>3/8</td><td>3/8</td></tr> <tr><td>MC-06 x 08</td><td>3/8</td><td>1/2</td></tr> <tr><td>MC-04 x 08</td><td>1/4</td><td>1/2</td></tr> <tr><td>MC-08 x 08</td><td>1/2</td><td>1/2</td></tr> <tr><td>MC-08 x 12</td><td>1/2</td><td>3/4</td></tr> <tr><td>MC-10 x 12</td><td>5/8</td><td>3/4</td></tr> </tbody> </table>	Item No.	Tube O.D.	IN NPT	MC-04 x 02	1/4	1/8	MC-04 x 04	1/4	1/4	MC-04 x 06	1/4	3/8	MC-06 x 06	3/8	3/8	MC-06 x 08	3/8	1/2	MC-04 x 08	1/4	1/2	MC-08 x 08	1/2	1/2	MC-08 x 12	1/2	3/4	MC-10 x 12	5/8	3/4															
Item No.	Tube O.D.	IN																																																																																				
SN2-04	1/4																																																																																					
SN2-05	5/16																																																																																					
SN2-06	3/8																																																																																					
SN2-08	1/2																																																																																					
SN2-10	5/8																																																																																					
Item No.	Tube O.D.	IN																																																																																				
U-04	1/4																																																																																					
U-05	5/16																																																																																					
U-06	3/8																																																																																					
U-08	1/2																																																																																					
U-10	5/8																																																																																					
U-12	3/4																																																																																					
Item No.	Tube O.D.	IN NPT																																																																																				
MC-04 x 02	1/4	1/8																																																																																				
MC-04 x 04	1/4	1/4																																																																																				
MC-04 x 06	1/4	3/8																																																																																				
MC-06 x 06	3/8	3/8																																																																																				
MC-06 x 08	3/8	1/2																																																																																				
MC-04 x 08	1/4	1/2																																																																																				
MC-08 x 08	1/2	1/2																																																																																				
MC-08 x 12	1/2	3/4																																																																																				
MC-10 x 12	5/8	3/4																																																																																				
<p><b>STRONG SHORT NUT</b></p>  <table border="1"> <thead> <tr> <th>Item No.</th> <th>Tube O.D.</th> <th>IN</th> </tr> </thead> <tbody> <tr><td>N-04</td><td>1/4</td><td></td></tr> <tr><td>N-06</td><td>3/8</td><td></td></tr> <tr><td>N-08</td><td>1/2</td><td></td></tr> <tr><td>N-10</td><td>5/8</td><td></td></tr> </tbody> </table>	Item No.	Tube O.D.	IN	N-04	1/4		N-06	3/8		N-08	1/2		N-10	5/8		<p><b>REDUCER</b></p>  <table border="1"> <thead> <tr> <th>Item No.</th> <th>Tube O.D.</th> <th>IN</th> </tr> </thead> <tbody> <tr><td>R-04 x 06</td><td>1/4</td><td>3/8</td></tr> <tr><td>R-06 x 04</td><td>3/8</td><td>1/4</td></tr> <tr><td>R-08 x 06</td><td>1/2</td><td>3/8</td></tr> <tr><td>R-08 x 10</td><td>1/2</td><td>5/8</td></tr> <tr><td>R-10 x 08</td><td>5/8</td><td>1/2</td></tr> <tr><td>R-12 x 10</td><td>3/4</td><td>5/8</td></tr> <tr><td>R-12 x 08</td><td>3/4</td><td>1/2</td></tr> <tr><td>R-10 x 12</td><td>5/8</td><td>3/4</td></tr> </tbody> </table>	Item No.	Tube O.D.	IN	R-04 x 06	1/4	3/8	R-06 x 04	3/8	1/4	R-08 x 06	1/2	3/8	R-08 x 10	1/2	5/8	R-10 x 08	5/8	1/2	R-12 x 10	3/4	5/8	R-12 x 08	3/4	1/2	R-10 x 12	5/8	3/4	<p><b>FEMALE CONNECTOR</b></p>  <table border="1"> <thead> <tr> <th>Item No.</th> <th>Tube O.D.</th> <th>IN NPS</th> </tr> </thead> <tbody> <tr><td>FC-04 x 02</td><td>1/4</td><td>1/8</td></tr> <tr><td>FC-04 x 04</td><td>1/4</td><td>1/4</td></tr> <tr><td>FC-04 x 06</td><td>1/4</td><td>3/8</td></tr> </tbody> </table>	Item No.	Tube O.D.	IN NPS	FC-04 x 02	1/4	1/8	FC-04 x 04	1/4	1/4	FC-04 x 06	1/4	3/8																														
Item No.	Tube O.D.	IN																																																																																				
N-04	1/4																																																																																					
N-06	3/8																																																																																					
N-08	1/2																																																																																					
N-10	5/8																																																																																					
Item No.	Tube O.D.	IN																																																																																				
R-04 x 06	1/4	3/8																																																																																				
R-06 x 04	3/8	1/4																																																																																				
R-08 x 06	1/2	3/8																																																																																				
R-08 x 10	1/2	5/8																																																																																				
R-10 x 08	5/8	1/2																																																																																				
R-12 x 10	3/4	5/8																																																																																				
R-12 x 08	3/4	1/2																																																																																				
R-10 x 12	5/8	3/4																																																																																				
Item No.	Tube O.D.	IN NPS																																																																																				
FC-04 x 02	1/4	1/8																																																																																				
FC-04 x 04	1/4	1/4																																																																																				
FC-04 x 06	1/4	3/8																																																																																				
<p><b>FORGED NUT</b></p>  <table border="1"> <thead> <tr> <th>Item No.</th> <th>Tube O.D.</th> <th>IN</th> </tr> </thead> <tbody> <tr><td>N-10</td><td>5/8</td><td></td></tr> <tr><td>N-12</td><td>3/4</td><td></td></tr> <tr><td>N-14</td><td>7/8</td><td></td></tr> </tbody> </table>	Item No.	Tube O.D.	IN	N-10	5/8		N-12	3/4		N-14	7/8		<p><b>REDUCING UNION</b></p>  <table border="1"> <thead> <tr> <th>Item No.</th> <th>Tube O.D.</th> <th>IN</th> </tr> </thead> <tbody> <tr><td>RU-05 x 04</td><td>5/16</td><td>1/4</td></tr> <tr><td>RU-06 x 04</td><td>3/8</td><td>1/4</td></tr> <tr><td>RU-08 x 04</td><td>1/2</td><td>1/4</td></tr> <tr><td>RU-08 x 06</td><td>1/2</td><td>3/8</td></tr> <tr><td>RU-10 x 06</td><td>5/8</td><td>3/8</td></tr> <tr><td>RU-10 x 08</td><td>5/8</td><td>1/2</td></tr> <tr><td>RU-12 x 08</td><td>3/4</td><td>1/2</td></tr> </tbody> </table>	Item No.	Tube O.D.	IN	RU-05 x 04	5/16	1/4	RU-06 x 04	3/8	1/4	RU-08 x 04	1/2	1/4	RU-08 x 06	1/2	3/8	RU-10 x 06	5/8	3/8	RU-10 x 08	5/8	1/2	RU-12 x 08	3/4	1/2	<p><b>VALVE CORE</b></p> <p>VCR-04 -1/4"</p>  <p><b>FLARE CAP</b></p> <p>FCP-640-04 -1/4"</p> 																																																
Item No.	Tube O.D.	IN																																																																																				
N-10	5/8																																																																																					
N-12	3/4																																																																																					
N-14	7/8																																																																																					
Item No.	Tube O.D.	IN																																																																																				
RU-05 x 04	5/16	1/4																																																																																				
RU-06 x 04	3/8	1/4																																																																																				
RU-08 x 04	1/2	1/4																																																																																				
RU-08 x 06	1/2	3/8																																																																																				
RU-10 x 06	5/8	3/8																																																																																				
RU-10 x 08	5/8	1/2																																																																																				
RU-12 x 08	3/4	1/2																																																																																				
<p><b>CAP NUT</b></p>  <table border="1"> <thead> <tr> <th>Item No.</th> <th>Tube O.D.</th> <th>IN</th> </tr> </thead> <tbody> <tr><td>CN-04</td><td>1/4</td><td></td></tr> <tr><td>CN-05</td><td>5/16</td><td></td></tr> <tr><td>CN-06</td><td>3/8</td><td></td></tr> <tr><td>CN-08</td><td>1/2</td><td></td></tr> <tr><td>CN-10</td><td>5/8</td><td></td></tr> <tr><td>CN-12</td><td>3/4</td><td></td></tr> </tbody> </table>	Item No.	Tube O.D.	IN	CN-04	1/4		CN-05	5/16		CN-06	3/8		CN-08	1/2		CN-10	5/8		CN-12	3/4																																																																		
Item No.	Tube O.D.	IN																																																																																				
CN-04	1/4																																																																																					
CN-05	5/16																																																																																					
CN-06	3/8																																																																																					
CN-08	1/2																																																																																					
CN-10	5/8																																																																																					
CN-12	3/4																																																																																					
<p><b>PLUG</b></p>  <table border="1"> <thead> <tr> <th>Item No.</th> <th>Tube O.D.</th> <th>IN</th> </tr> </thead> <tbody> <tr><td>P-04</td><td>1/4</td><td></td></tr> <tr><td>P-05</td><td>5/16</td><td></td></tr> <tr><td>P-06</td><td>3/8</td><td></td></tr> <tr><td>P-08</td><td>1/2</td><td></td></tr> <tr><td>P-10</td><td>5/8</td><td></td></tr> <tr><td>P-12</td><td>3/4</td><td></td></tr> </tbody> </table>	Item No.	Tube O.D.	IN	P-04	1/4		P-05	5/16		P-06	3/8		P-08	1/2		P-10	5/8		P-12	3/4																																																																		
Item No.	Tube O.D.	IN																																																																																				
P-04	1/4																																																																																					
P-05	5/16																																																																																					
P-06	3/8																																																																																					
P-08	1/2																																																																																					
P-10	5/8																																																																																					
P-12	3/4																																																																																					

**REFRIGERANT GAUGE**



**RG-250**

Blue metal frame & PC cover  
 Pressure : 30 vacuum 250 psi  
 Refrigerant : R22 R134a R404a R12  
 connection : 1/8"NPT 2-3/4"dia



**RG-500**

Red metal frame & PC cover  
 Pressure : 0 to 500 psi  
 Refrigerant : R22 R134a R404a R12  
 connection : 1/8"NPT 2-3/4"dia



**RG-500/410**

Blue metal frame & PC cover  
 Pressure : 30 vacuum 500 psi  
 Refrigerant : R410a R32  
 connection : 1/8"NPT 2-3/4"dia



**RG-800/410**

Red metal frame & PC cover  
 Pressure : 0 to 800 psi  
 Refrigerant : R410a R32  
 connection : 1/8"NPT 2-3/4"dia

**ORG(u)-230**

2-1/2" dia, Oilfilled, Stainless frame with ring for back mounting  
 Pressure : 30 vacuum to 230 psi  
 Refrigerant : R22 R134A R404A R407C  
 Connection : 1/4" SAE

**ORG(u)-500**

2-1/2" dia, Oilfilled, Stainless frame with ring for back mounting  
 Pressure : 30 vacuum to 500 psi  
 Refrigerant : R22 R134A R404A R407C  
 Connection : 1/4" SAE

**ORG(b)-230**

2-1/2" dia, Oilfilled, Stainless frame with ring for front mounting  
 Pressure : 30 vacuum to 230 psi  
 Refrigerant : R22 R134A R404A R407C  
 Connection : 1/4" SAE

**ORG(b)-500**

2-1/2" dia, Oilfilled, Stainless frame with ring for front mounting  
 Pressure : 30 vacuum to 500 psi  
 Refrigerant : R22 R134A R404A R407C  
 Connection : 1/4" SAE

### FREON GAUGE

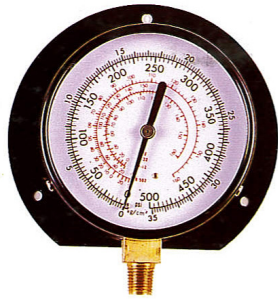

#### BFG-500

High side 0 vacuum to 500 psi, 1/4" NPT connection, 4" dia, black color with steel frame.

#### BFG-250

Low side 30 vacuum to 250 psi, 1/4" NPT connection, 4" dia, black color with steel frame.

### PRESSURE GAUGE

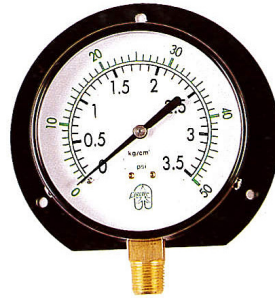

4" dia, black color with steel frame. 1/4" NPT or 3/8" NPT connection.

PB-50	0~3.5 kg/cm <sup>2</sup> or 50 psi
PB-100	0~ 7 kg/cm <sup>2</sup> or 100psi
PB-150	0~ 10 kg/cm <sup>2</sup> or 150psi
PB-200	0~ 15 kg/cm <sup>2</sup> or 200psi
PB-250	0~ 20 kg/cm <sup>2</sup> or 250psi



### POCKET THERMOMETER

#### PT-10

1" dia, -40°~70°C

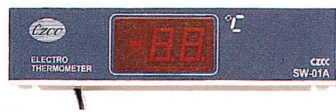

### ELECTRO THERMOMETER

#### SW-01A

-40°~99°C



### REFRIGERATOR THERMOMETER

#### RT-45

-40°~50°C

### YF-1110 VENTILATOR

Vent 110V or 220V/36W (175mm x 175mm sq.)

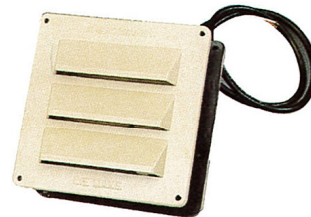

### Binding Type

Height: 5cm 7cm 10cm

Length: 30m 50m



### AC Digital Clamp Meter

#### YF-8070



- CAT II 600V
- 3-1/2 digit LCD with maximum reading of 2000.
- AC voltage range: 200V, 750V.
- AC current range: 20A, 200A, 600A.
- Resistance measurement to 2000 ohms.
- Data Hold, Peak Hold.
- Test Ranges: ACV, ACA, Resistance, Freq, Continuity.
- Frequency (non-contact frequency measurement)
- Low battery indication.

Maximum Current	600 Amps
Display	2000 counts
Max. Conductor Size	35mm
AC Current	10mA to 600A, $\pm(2.0\%$ of rdg + 5 dgts)
AC Voltage	0.1V to 750V, $\pm(1.2\%$ of rdg + 3 dgts)
Resistance	1 $\Omega$ to 2000 $\Omega$ , $\pm(1.0\%$ of rdg + 2 dgts)
Continuity Buzzer	Yes
Frequency	1Hz to 5MHz, $\pm(0.8\%$ of rdg + 3 dgts)
Peak and Data Hold	Yes
Dimensions	221mm (L) x 62mm (W) x 35mm (D)
Weight	330g

### AC HVAC Clamp Meter

#### TM-1016



- CAT III 600V
- 2.3-3/4 digit LCD Backlit Display, with Analog Bargraph.
- Display Counts: 4000.
- Auto Ranging.
- AC/DC current: 0.1 $\mu$ A to 4000 $\mu$ A.
- AC current: 0.01A to 400A
- Ranges: ACV, ACA, DCV, DCA, Resistance, Continuity, Capacitance, and Temperature.
- Maximum conductor size 30mm.
- Continuity test below 40 ohms, buzzer will sound.
- Auto Power off.
- Double injection outer case.

Maximum Current	400 Amps
Display Counts	4000 (Backlit display)
Maximum Conductor Size	30mm
AC Current Range	0.1 $\mu$ A to 4000 $\mu$ A/0.1A to 400A, $\pm(2.0\%$ of rdg + 10 dgts)
AC Voltage Range	0.1mV to 600V, $\pm(1.0\%$ of rdg + 3 dgts)
DC Voltage Range	0.1mV to 600V, $\pm(0.8\%$ of rdg + 2 dgts)
DC Current	0.1 $\mu$ A to 4000 $\mu$ A, $\pm(2.0\%$ of rdg + 10 dgts)
Continuity Buzzer	Yes
Data Hold	Yes
Capacitance	10pF to 4mF
Temperature (Type 'K')	-50°C to 1200°C
Power Supply	2 1.5V type 'AAA' batteries
Resistance	0.1 ohm to 40 megohms $\pm(0.8\%$ + 2 dgts)
Dimensions	205mm (L) x 64mm (W) x 39MM (D)
Weight	280g approx. including batteries

### TUBE BENDER



**364-04-1/4"** For 1/4" / 6mm O.D. tubing 180° degree bent.  
**364-05-5/16"** For 5/16" / 8mm O.D. tubing 180° degree bent.

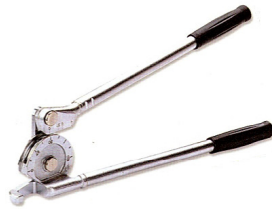

**364-06-3/8"** For 3/8" / 10mm O.D. tubing 180° degree bent.  
**364-08-1/2"** For 1/2" / 12mm O.D. tubing 180° degree bent.



**364-10-5/8"** For 5/8" / 16mm O.D. tubing 180° degree bent.  
**364-12-3/4"** For 3/4" / 19mm O.D. tubing 180° degree bent.  
**364-14-7/8"** For 7/8" / 22mm O.D. tubing 180° degree bent.

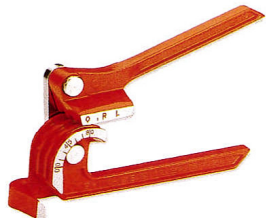

**368 3-IN-1 TUBE BENDER** For 1/4", 5/16", 3/8" O.D. tubing 90° degree bent.  
**368M 3-IN-1 TUBE BENDER** For 6mm, 8mm, 10mm O.D. tubing 90° degree bent.



**366 4-IN-1 BENDER** For 3/16", 1/4", 5/16", 3/8" O.D. Tubing With fixed hook, bends up to 180°.



**367 3-IN-1 BENDER** For 1/4", 5/16", 3/8" O.D. Tubing With fixed hook, bends up to 180°.  
**367M 3-IN-1 BENDER** For 6mm, 8mm, 10mm O.D. tubing With fixed hook, bends up to 180°.

### ECCENTRIC CONE TYPE FLARING TOOL

- 806A** Eccentric Cone Type Flaring Tool for 1/4", 5/16", 3/8", 1/2", 5/8" & 3/4" O.D. tubing.
- 806M** Eccentric Cone Type Flaring Tool for 6, 8, 10, 12, 14 & 19mm O.D. tubing.
- 808A** Eccentric Cone Type Flaring Tool for 3/16", 1/4", 5/16", 3/8", 1/2", 5/8" & 3/4" O.D. tubing.
- 808M** Eccentric Cone Type Flaring Tool for 6, 8, 10, 12, 14, 16 & 19mm O.D. tubing.



### ECCENTRIC CONE TYPE FLARING TOOL KITS

- 806AL** Kit include CT-806A 45° Eccentric Cone Type flaring tool, 274-FC tube cutter, 208-F reamer.
- 806ML** Kit include CT-806M 45° Eccentric Cone Type flaring tool, 274-FC tube cutter, 208-F reamer.
- 808AL** Kit include CT-808A 45° Eccentric Cone Type flaring tool, 274-FC tube cutter, 208-F reamer.
- 808ML** Kit include CT-808M 45° Eccentric Cone Type flaring tool, 274-FC tube cutter, 208-F reamer.

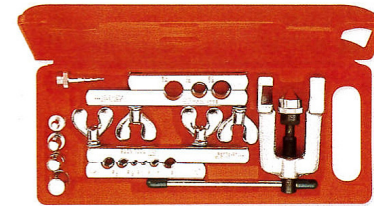

### FLARING & SWAGING TOOL 275L

Flares 1/8", 3/16", 1/4", 5/16", 3/8", 7/16, 1/2", 5/8 and 3/4" O.D. (1/8", 1/4", 3/8", 1/2", 5/8" nom.) Includes 5 swage adapters which cover 3/16", 1/4", 5/16", 3/8", 1/2", 5/8", 3/4", O.D. (1/8", 1/4", 3/8", 1/2", 5/8" nom.) in hand carrying case.



### DOUBLE FLARING TOOLKIT

Flares 3/16", 1/4", 5/16", 3/8", 1/2" O.D. tubing including 5 adapter for 3/16", 1/4", 5/16", 3/8", 1/2" O.D. tubing and 274-FC tube cutter. Screwing down flaring cone with proper adapter, and then back flaring cone to remove adapter, flared finished.



**FLARING TOOL  
500-FA** For 3/16", 1/4", 5/16", 3/8", 1/2" and 5/8" O.D. tubing.



### FLARING & CHITTING KIT 1226-FA

Contains of kit : 274-FC tube cutter 195-FC flaring tool.

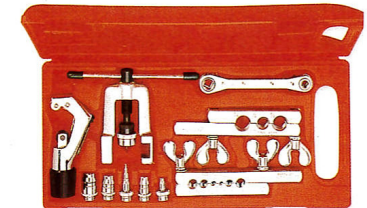

### FLARING & CHITTING KIT 278L

Contains of kit : 275-FS flaring & swaging tool, CH-274 tube cutter, 122-FC ratchet wrench in plastic case.



**FLARING TOOL  
195-FC** For 3/16", 1/4", 5/16", 3/8", 7/16", 1/2", and 5/8" O.D. tubing.



**FLARING TOOL  
525** For 3/16" - 5/8" O.D. tubing. One opening holds all sizes.

### Multi Size Tube Bender

Bending worked by ratchet which can save power and efficiency bending

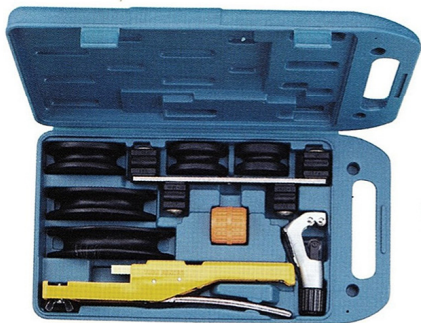

**YF-404L**

Including **274-FC tube cutter**, plastic reamer and **5 form wheels** in the case  
Size : 3/8", 1/2", 5/8", 3/4", 7/8", O.D..tubing.



**YF-404BL** 6 form **imperial unit** wheels

Size : 3/8", 1/2", 5/8", 3/4", 7/8", 1-1/8" O.D.tubing.

**YF-505M** 7 form **Metric system** wheels

Size : 8, 10, 12, 14, 16, 18, 22mm O.D.tubing.

### Multi Size Tube Expander Kit



**YF-1000**

Including **208 plastic reamer** and **6 expand heads**  
Imperial Size : 3/8", 1/2", 5/8", 3/4", 7/8", 1" O.D..tubing.

**YF-2000**

Including **208 plastic reamer** and **6 expand heads**  
Metric Size : 10, 12, 15, 16, 18, 22mm O.D..tubing.

**YF-1000E**

Expand heads imperial size :  
3/8", 1/2", 5/8", 3/4", 7/8", 1", 1-1/8", 1-1/4", 1-3/8", 1-1/2", 1-5/8" O.D..tubing.

**YF-2000E**

Expand heads metric size :  
10, 12, 14, 15, 16, 18, 22, 28, 35, 42mm O.D..tubing.



**274-FC TUBE CUTTER**

CAPACITY : 1/8"~1-1/8" O.D. tubing  
Aluminum alloy body, chrome plated finish with a spare cutting blade.



**312-FC TUBE CUTTER**

CAPACITY : 1/4"~1-5/8" O.D. tubing  
Aluminum alloy body, chrome plated finish with a spare cutting blade.

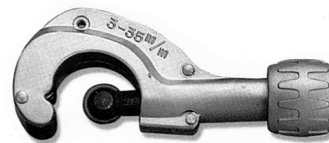

**105 TUBE CUTTER**

CAPACITY : 1/8"~1-3/8" O.D. tubing  
Aluminum alloy body, silver color painted with a spare cutting blade.



**107 TUBE CUTTER**

CAPACITY : 1/4"~2" O.D. tubing  
Aluminum alloy body, silver color painted with a spare cutting blade.



**104 TUBE CUTTER**

CAPACITY : 1/4"~1-1/4" O.D. tubing  
Aluminum alloy body, red color painted with a spare cutting blade.



**206-FB TUBE CUTTER**

CAPACITY : 3/8"~2-5/8" O.D. tubing  
Aluminum alloy body, chrome plated finish with a spare cutting blade.

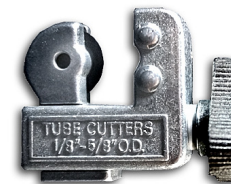

**127-FB TUBE CUTTER**

CAPACITY : 1/8"~5/8" O.D. tubing  
Zinc alloy body, zinc plated finish.



#### CUTTING BLADE

274B/312B : For 274-FC/312-FC, SUJ2 Material  
105B/107B : For 105/107, SUJ2 Material  
104B : For 104, SUJ2 Material  
127B : For 127-FB, SUJ2 Material



**CAPILLARY TUBE CUTTER**

**YF-128**  
Cuts all sizes of capillary tubes without collapsing nor swaging the tubes.

**PVC PIPE CUTTER**

**YF-42** Professional PVC cutter capacity up to 42mm.  
**YF-35** Professional PVC cutter capacity up to 35mm.

**201-FF PINCH OFF PLIER**  
Pinch off plier 7" can pinch off copper tubing instantly.

**INNER-OUTER REAMER**  
Reams Both Inside and Outside Edges of Tubing

**208-F**  
Plastic body, 3/16"~1-1/2" O.D.

**209-F**  
Zinc body, 1/4"~1-5/8" O.D.

**YF-352 FIN TOOL**  
Fin straightener stainless steel, can clean & straighten evaporator fin.

**SPRING BENDER**

YF-102-04 Size 1/4" Length 10"  
YF-102-05 Size 5/16" Length 10"  
YF-102-06 Size 3/8" Length 10"  
YF-102-08 Size 1/2" Length 12"  
YF-102-10 Size 5/8" Length 14"  
YF-102-12 Size 3/4" Length 14"

**95-S SWAGING PUNCH** Swaging punch for 1/4", 5/16", 3/8", 1/2" & 5/8" O.D. 5-1/16" punch.

**94-S SWAGING PUNCH** 3-IN-1 1/2", 5/8", 7/8"

**93-S SWAGING PUNCH** 3/16", 1/4", 5/16", 3/8", 1/2", 5/8", 3/4", 7/8"

**204-FF PINCH-OFF TOOL** for 3/8" O.D.

**FC-351 FIN STRAIGHTENER**  
Fin straightener 8,9,10,12,14,15 spacing per inch.

**193-S SWAGING PUNCH**  
Swaging punch for 1/4", 5/16", 3/8", 1/2" & 5/8" O.D. tubing.

**122-FC RATCHET WRENCH**  
4 size : 1/4", 3/8, 3/16", 5/16" square ratchet

## Heat Exchanger Accumulators



Item Number	DIA inches	Length inches	Suction Line I.D.	Lique Line I.D.	Maximum Ref Rear Holding Capacity Lbs			Recommended Tons of Refrigeration														
					R134a	R-22	R404a	Refrigerant						R-502								
					Rear Temp	+40	+20	0	-20	-40	+40	+20	0	-20	-40	+40	+20	0	-20	-40		
SAV-2404	4	8-3/4	1/2	3/8	3	2.7	2.8	MAX 0.90	0.50	0.30	0.20	0.10	1.80	1.15	0.70	0.45	0.30	1.40	0.9	0.6	0.40	0.15
SAV-2405	4	10-5/8	5/8	3/8	3.4	4	4.2	MAX 1.00	0.60	0.40	0.25	0.15	2.00	1.25	0.85	0.55	0.35	1.55	1.00	0.70	0.45	0.25
SAV-2406	5-1/2	10	3/4	5/8	6.5	6	6.1	MAX 1.80	1.15	0.70	0.48	0.28	3.0	2.1	1.5	1.1	0.6	2.8	2.0	1.4	0.8	0.5
SAV-2407	5-1/2	13	7/8	5/8	8.5	7.8	8	MAX 2.5	1.8	1.0	0.7	0.4	4.0	3.0	2.3	1.5	0.9	4.0	3.0	2.0	1.3	0.7
SAV-2411	6-1/2	15-1/2	1-1/8	5/8	13.5	12	12.5	MAX 5.0	3.2	2.1	1.4	0.9	9.0	6.2	4.3	2.8	1.8	9.0	6.0	4.0	2.5	1.4
SAV-2413	6-1/2	20	1-3/8	3/4	18	16.5	17	MAX 8.0	6.0	3.8	2.4	1.4	17.0	11.0	7.7	5.0	3.0	15.0	10.0	7.0	4.5	2.5
SAV-2415	6-1/2	22-1/2	1-5/8	7/8	23	21	22	MIN 13	9	6	4	2	28	19	13	8	5	25	18	12	7	4

## Refrigerant Receivers



Item No.	Refrigerant Capacity (Lbs)			Dimensions (inches)		Connections Size	
	R-12	R-22	R-502	DIA.	H.	In.	OUT
CR-101	2.5	2.4	2.5	3-3/8	7.87	3/8"	1/4"
CR-102	6.1	5.8	6.0	5	10.24	3/8"	3/8"
CR-103	7	6.7	6.8	5	11.42	3/8"	3/8"
CR-104	10	9.5	9.8	6	13.78	1/2"	1/2"
CR-105	14	13.2	13.5	7	16.15	5/8"	5/8"
CR-106	17.6	16.6	17	6.5	23.63	3/4"	3/4"
CR-107	20.58	19.4	25	6.5	27.56	7/8"	7/8"

## Oil Separators



MODEL NO.	DIMENSIONS-INCHES		DIA. INCHES	CAPACITY IN TONS OF REFRIGERATION AT EVAPORATOR TEMPERATURE					
	SIZE CONN.	LENGTH		R-12		R-22		R-502	
				-40°F	+40°F	-40°F	+40°F	-40°F	+40°F
S-5201S	1/2 ODS	7 1/2	4	3/4	1	1	1 1/2	1	1 1/2
S-5201	1/2 ODS	10 1/4		1	1 1/2	2	1 1/2	2	2
S-5202	3/4 ODS	14 1/4		3	4	4 1/2	5 1/2	4 1/2	5 1/2
S-5203	3/4 ODS	16 3/4		4 1/2	5 1/2	7	8	7 1/2	8 1/2
S-5204	1 1/4 ODS	18		6	7 1/2	9	10 1/2	9 1/2	11 1/2
S-5205	1 1/4 ODS	19		7 1/2	10	11 1/2	13 1/2	12	14 1/2
S-5302	1/2 ODS	10 1/4	4	1	1 1/2	1 1/2	2	1 1/2	2
S-5303	3/4 ODS	14 1/4		3	4	4 1/2	5 1/2	4 1/2	5 1/2
S-5304	3/4 ODS	16 3/4		4 1/2	5 1/2	7	8	7 1/2	8 1/2
S-5305	1 1/4 ODS	18		6	7 1/2	9	10 1/2	9 1/2	11 1/2
S-5306	1 1/4 ODS	19		7 1/2	10	11 1/2	13 1/2	12	14 1/2
S-5307	1 1/4 ODS	19		7 1/2	10	11 1/2	13 1/2	12	14 1/2
S-6202	1 1/4 ODS	14 1/2	6	8	10	11	12	12	14
S-6203	1 3/4 ODS	16		9	12	13	14	15	20
S-6204	1 1/2 ODS	17 1/4		11	14	16	18	20	24
S-6205	2 1/4 ODS	19		17	22	25	30	30	35
S-6302	1 1/4 ODS	14 1/2		8	10	11	12	12	14
S-6303	1 1/4 ODS	16		9	12	13	14	15	20
S-6304	1 1/4 ODS	17 1/4	11	14	16	18	20	24	
S-6305	2 1/4 ODS	19	17	22	25	30	30	35	

## Refrigerant Accumulators



MODEL NO.	DIMENSIONS-INCHES			REFRIGERANT HOLDING CAP(LBS 0°F SAT)		
	size conn o.d.s	shell dia	shell length	R-134A	R-22	R-404A R-507
RA-204	1/2	4	8.47	3.5	3.3	3.4
RA-205	5/8	4	10.83	4.4	4	4.2
RA-206	3/4	5.5	10.24	6.1	6.8	6.2
RA-207	7/8	5.5	12.6	9.8	9	9.3
RA-211	1 1/8	6.5	15.75	14.2	13.3	13.7
RA-213	1 3/8	6.5	20.87	21.8	20.5	21.2
RA-215	1 5/8	6.5	22.84	23.8	22.6	23.1

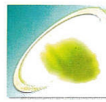

## • Shell & Tube Refrigerant Condensers



R-12 R-22 R-502 Safe working pressure 450 PSIG.

Item No.	Flow capacity tons	Cooper tubing connection		Overall dimensions (inches)		
		Refrigerant		Length	Dia.	Approx water tube length
		Tube size in/out	Tube size in/out			
ST-6101	1	3/8" SAE	1/2" FPS	10-1/4"	6"	3/4" OD x 72"
ST-6102	2	3/8" SAE	1/2" FPS	11-3/4"	6"	3/4" OD x 118"
ST-6103	3	1/2" SAE	3/4" FPS	13-3/4"	8"	7/8" OD x 175"
ST-6105	5	5/8" SAE	1" FPS	18"	8-1/2"	7/8" OD x 348"

## • Double Tube Condenser



R-12 R-22 R-502 Safe working pressure 500 PSIG

Item No.	Flow capacity tons	Copper tubing connections				Dimensions			
		Refrigerant		Water		Body length (L)	Height (D)	Width (W)	Approx water tube length
		Tube size in/out	Wall (inches)	Tube size in/out	Wall (inches)				
DT-5201	1	1/2" OD	0.028	3/4" OD	0.028	9-3/4"	6"	8-1/4"	3/4" OD x 132"
DT-5202	2	1/2" OD	0.028	3/4" OD	0.028	11-1/2"	9"	8-1/4"	3/4" OD x 138"
DT-5203	3	1/2" OD	0.028	3/4" OD	0.032	12-3/4"	11-1/2"	9-3/4"	7/8" OD x 175"
DT-5205	5	5/8" OD	0.035	1" OD	0.046	17-3/4"	14-1/2"	11-1/2"	7/8" OD x 348"

## • Potential Relays

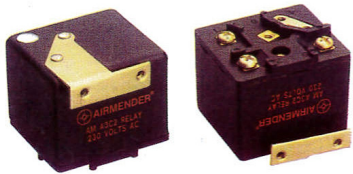

ITEM NO.	H.P.	VOLTS	CONTINUOUS COIL VOLTAGE	PICK UP	DROP OUT
AM-A3C2	3/4, 1, 1-1/2, 2	208/230	332	280-309	55-100
AM-A3D3	3/4, 1	230	332	299-327	50-100
AM-A3R3	1/2, 3/4, 1, 1-1/2	115	332	171-184	40-90
AM-A4A3	2, 3, 4, 5	230	502	239-268	60-135
AM-A4D3	1-1/2, 2, 3, 4, 5	230	502	295-324	60-135
AM-A5C2	1/2, 3/4, 1	230	253	278-306	35-77



## FANYALON THERMAL INSULATION SERIES



- \* Pass the **UL 94V-0** flame resistance test
- \* Pass the **FMVSS 302** burn rate testing
- \* Pass **BS476** surface spread of flame
- \* Pass **ARTC** flammability of interior materials
- \* US-American thermal conductivity **ASTMC518**
- \* JAPAN thermal conductivity **JIS A1412**
- \* Pass the **EU 2011/65 / EU Annex II...**

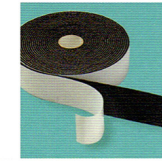
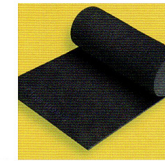
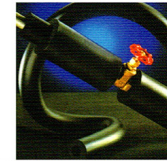

- Applicable range of temperature -58°C~130°C
- Self-extinguishing.
- Weather-proof.
- Softness.
- Flexibility.
- Economical.
- The hermetic air form structure
- Low in water absorption
- Low K value of conductivity coefficient

## FANYALON THERMAL SHEET

**NP-620**

Size : 3'x4'x1/8"  
3'x4'x1/4"  
3'x4'x3/8"  
3'x4'x1/2"  
3'x4'x5/8"  
3'x4'x3/4"

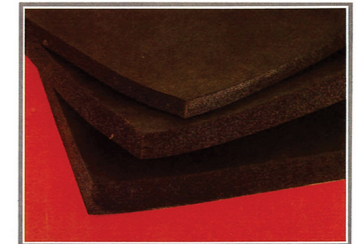

## FANYALON THERMAL PIPE

**NP-610** Thickness : 3/8", 1/2", 5/8", 3/4"  
I.D.(inch) : 3/8"-5"

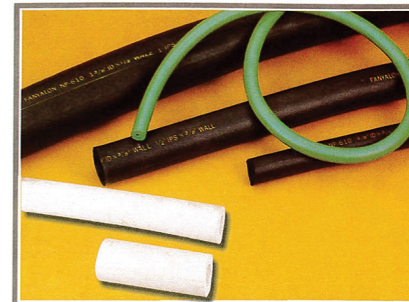

## FANYALON FOAM INSULATION TAPE

**NP-630** Size : 30'x2"x1/8"

